

FOOTING QUANTITIES AND DEPTHS  
FROM GROUND LEVEL

ITEM	QTY	HOLE DIAMETER	HOLE DEPTH
POST	2	400	600

NOTE:

THIS PRODUCT IS DESIGNED FOR 300MM  
SOFT FALL. CHECK THE PROPOSED ON SITE  
SOFT FALL DEPTH. IF IT IS NOT 300MM PLEASE  
ADJUST DEPTHS OF POST HOLES ACCORDINGLY, TO  
ACHIEVE CORRECT OVERALL SUBSURFACE DEPTH.  
THIS WILL MAINTAIN CORRECT HEIGHT OF  
EQUIPMENT ABOVE UNDERSURFACE LEVEL.

FALL ZONE  
FALL HEIGHT 1.9M  
APPROX. 12.5SQM

R1725.0

3450.0

JOB N°	PLANNED BY		UNLESS STATED OTHERWISE - ALL DIMENSIONS ARE IN MILLIMETRES. GENERAL TOLERANCES: DIN ISO 2768-MK						
	PLAN DATE								
JOB NAME	MADE BY	DRAWN	DE	ITEM N°  A-NAT-2223		SF LOG TRUNK LADDER			
		DATE	2/14/2024						
	MFG DATE	CHECKED		STOCK / LEGACY N°  PNI445		DRAWING N°  A-NAT-2223-001			
		DATE							
© 2024 THE PLAY COLLECTIVE ABN 28 101 472 619. THE INFORMATION CONTAINED IN THIS DRAWING IS THE SOLE PROPERTY OF THE PLAY COLLECTIVE. ANY REPRODUCTION IN PART OR WHOLE WITHOUT THE WRITTEN PERMISSION OF THE PLAY COLLECTIVE IS PROHIBITED. ANY UNCERTAIN DIMENSIONS ARE TO BE CONFIRMED BY PLAY COLLECTIVE BEFORE COMMENCEMENT OF MANUFACTURING.						REV	SCALE: NTS	SHT 1 OF 2	A3

FOOTING QUANTITIES AND DEPTHS  
FROM GROUND LEVEL

ITEM	QTY	HOLE DIAMETER	HOLE DEPTH
Post	2	400	600

NOTE:

THIS PRODUCT IS DESIGNED FOR 300MM  
SOFT FALL. CHECK THE PROPOSED ON SITE  
SOFT FALL DEPTH. IF IT IS NOT 300MM PLEASE  
ADJUST DEPTHS OF POST HOLES ACCORDINGLY, TO  
ACHIEVE CORRECT OVERALL SUBSURFACE DEPTH.  
THIS WILL MAINTAIN CORRECT HEIGHT OF  
EQUIPMENT ABOVE UNDERSURFACE LEVEL.

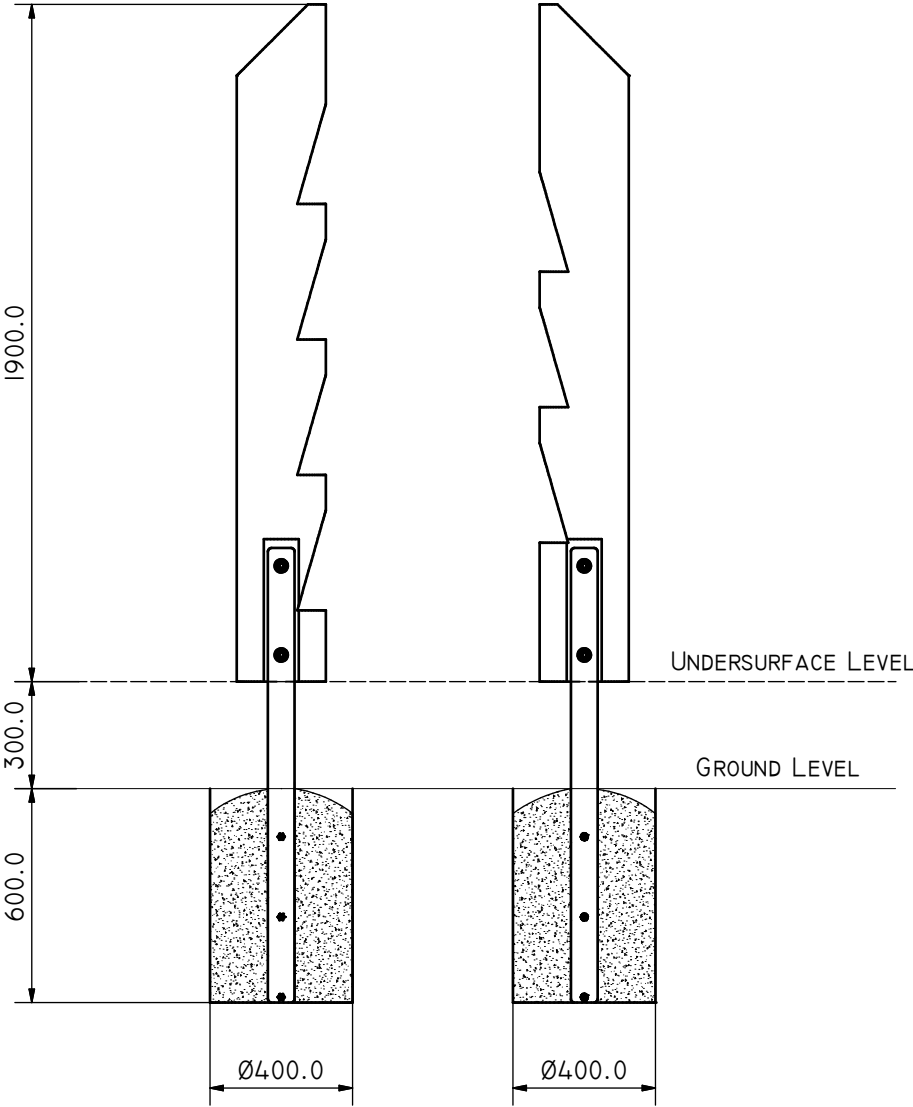

JOB N°	PLANNED BY		UNLESS STATED OTHERWISE - ALL DIMENSIONS ARE IN MILLIMETRES. GENERAL TOLERANCES: DIN ISO 2768-MK						
	PLAN DATE								
JOB NAME	MADE BY	DRAWN	DE	ITEM N°		SF LOG TRUNK LADDER			
		DATE	2/14/2024	A-NAT-2223					
	MFG DATE	CHECKED		STOCK / LEGACY N°		DRAWING N° A-NAT-2223-002			
		DATE		PNI445					
© 2024 THE PLAY COLLECTIVE ABN 28 101 472 619. THE INFORMATION CONTAINED IN THIS DRAWING IS THE SOLE PROPERTY OF THE PLAY COLLECTIVE. ANY REPRODUCTION IN PART OR WHOLE WITHOUT THE WRITTEN PERMISSION OF THE PLAY COLLECTIVE IS PROHIBITED. ANY UNCERTAIN DIMENSIONS ARE TO BE CONFIRMED BY PLAY COLLECTIVE BEFORE COMMENCEMENT OF MANUFACTURING.						REV	SCALE: NTS	SHT 2 OF 2	A3